

Project: New York Capital Region Sustainability Maps

Canvas: Albany

Created By: Darin Dinsmore

Date Created: June 18th, 2012

Privacy: Public Canvas

Votes: 10

Recommendations: No

Goal:

Dates: Starts June 18th, 2012 Ends September 18th, 2012

Legend

Title	Description
	Existing Projects
	Proposed Projects
	Best Practices
	Strategies
	Instructions
	Other

The Crowd

Participant	Ideas
Mary Millus	10
Angela Vincent	5
Clare Gaffey	3
Daley	3
Doug Melnick	1
Elizabeth Staubach	1
Greenberg	1
Jackson Davis	1
Kevin Jones	1
Rusch	1
Anne Benware	0
barrett	0
Brandon	0
Clark	0
copenhaver	0
Darin Dinsmore	0

DiBetta	0
Eric Tuvel	0
ERIK DEYOE	0
Feffer	0
Ferraro	0
Heidi Hill Drum	0
Jean Loewenstein	0
John Smolinsky	0
Kay Simonsry	0
Martin Daley	0
Mary Ellen Mallia	0
Murnane	0
nicole frazer	0
Noah Bernstein	0
noonan	0
Rightmyer	0
Rosenthal	0
Rugg	0
Sandra Steubing	0
Sara Barz	0
Sarah Crowell	0
Thomas Cole	0
Tom Crowell	0
Wortman	0

Brite Ideas

<u>Idea</u>	<u>Votes</u>
Re-establish bike and pedestrian accommodations on the replacement Livingston Avenue Bridge to connect the Corning Preserve to Rennselaer	3
Central Warehouse is an ideal location for an Aquarium!	3
Albany Bike Master Plan	3
Facade and streetscape improvements along Quail St. between Central and Western Avenue	2
Corning Preserve Bike Trail along Hudson River	2
City of Albany TOD Zoning	2
Washington - Western BRT	2

Complete development of the Helderberg Hudson Rail Trail between Voorheesville and the Port of Albany 1

Capital Region Timebanks (<http://CapitalRegion.Timebanks.org>) Join this free effort and help to build a more sustainable community in which We the People are the most valuable assets. See our website for more info and to attend a local orientation. Together we are "Fixing the Future". 1

Repave 85 1

Put in a roundabout with a flowing water fountain or water conservation and collection system / rain garden. 1

Madison Ave Road Diet Feasability Study 1

Light Rail connection to Troy and other neighboring cities/communities

All of the City of Albany Police Stations and Fire Houses had energy efficient lighting retrofits within the past couple of years. They were done through National Grid's Energy Efficiency program, which provided up to 70% cash incentive for each project.

Solar Panels on SUNY Albany Campus Roofs

Include an environmental awareness festival in the curriculum for summer events in Albany

New York State Museum

Clearcutting Pine Bush for Nanotech campus

Daylight Fox Creek in Sheridan Hollow

Daylight Patroon Creek and connect it to Tivoli Lake

NY5 BRT - Albany - Colonie - Schenectady

Redevelop Harriman Campus as a mixed-use innovation community.

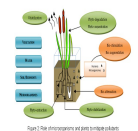
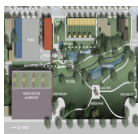

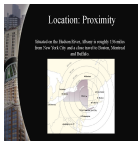

Harriman Campus

- Harriman Campus located adjacent to the University at Albany State Office Building, 150 College of Environmental Science and Forestry and the growing 1000,000 sq ft complex.
- Located near the main State Office Building, 150 College of Environmental Science and Forestry and the growing 1000,000 sq ft complex.

Comment Threads

- Albany Bike Master Plan

Install bike lanes in between sidewalks and parked cars to avoid having people ride so intertwined with vehicles.

Comment By: Clare Gaffey - August 1st, 2012 at 11:54am MDT

- New York State Museum

New York State Museum
 Empire State Plaza
 Madison Avenue
 Albany, NY 12210
 (518) 474-5877

Comment By: Jackson Davis - August 2nd, 2012 at 2:51pm MDT

- Clearcutting Pine Bush for Nanotech campus

This is the opposite of a sustainable idea.

Comment By: Clare Gaffey - August 11th, 2012 at 9:45pm MDT

-

Floating gardens for phytoremediation.

Comment By: Mary Millus - July 24th, 2012 at 12:57pm MDT

-

Plants can extract contaminants with their roots (Phyto-extraction), immobilize the contaminant in their roots (Phyto-stabilisation), trap (Phyto-sequestration) and/or degrade it by their metabolism (Phyto-degradation).

Comment By: Mary Millus - July 24th, 2012 at 12:49pm MDT

-

Illegible

Comment By: Jackson Davis - July 29th, 2012 at 5:01pm MDT

Ideas Sorted By Legend

Existing Projects

Idea	Votes
Albany Bike Master Plan	3
Corning Preserve Bike Trail along Hudson River	2

Capital Region Timebanks (<http://CapitalRegion.Timebanks.org>) Join this free effort and help to build a more sustainable community in which We the People are the most valuable assets. See our website for more info and to attend a local orientation. Together we are "Fixing the Future". 1

All of the City of Albany Police Stations and Fire Houses had energy efficient lighting retrofits within the past couple of years. They were done through National Grid's Energy Efficiency program, which provided up to 70% cash incentive for each project.

Solar Panels on SUNY Albany Campus Roofs

New York State Museum

Clearcutting Pine Bush for Nanotech campus

NY5 BRT - Albany - Colonie - Schenectady

Proposed Projects

Idea	Votes
Central Warehouse is an ideal location for an Aquarium!	3
Washington - Western BRT	2
Complete development of the Helderberg Hudson Rail Trail between Voorheesville and the Port of Albany	1
Repave 85	1
Put in a roundabout with a flowing water fountain or water conservation and collection system / rain garden.	1
Madison Ave Road Diet Feasability Study	1
Light Rail connection to Troy and other neighboring cities/communities	
Include an environmental awareness festival in the curriculum for summer events in Albany	
Daylight Fox Creek in Sheridan Hollow	
Daylight Patroon Creek and connect it to Tivoli Lake	

Best Practices

Idea	Votes
City of Albany TOD Zoning	2

Strategies

Idea	Votes
Facade and streetscape improvements along Quail St. between Central and Western Avenue	2
Redevelop Harriman Campus as a mixed-use innovation community.	

Instructions

Idea	Votes
Re-establish bike and pedestrian accommodations on the replacement Livingston Avenue Bridge to connect the Corning Preserve to Rennselaer	3

Other

Idea	Votes
------	-------

